

50W RGB+CCT Smart LED Garden Light (Zigbee 3.0+2.4GHz)

Model No.: FUTC12ZR

Product Feature

- 16 millions color
- Dim RGB/CCT/Brightness, CCT range 2700K-6500K
- Zigbee 3.0+2.4G wireless transmission technology
- One light max work with 12pcs 2.4G RF remote (control distance 30m)
- 18 dynamic mode with jumping and changing gradually (only work with 2,4G RF remote)
- Auto-forwarding: Automatically forward the remote control signal to another master box, making the remote control distance infinite
- Have DND function, usually used in power failure area and save power
- Support TUYA SMART app control (Zigbee 3.0 gateway is needed)
- Support third party voice control like Alexa, Google assistant,Yandex Alice, Tmall Genie,Baidu and Xiaomi (Zigbee 3.0 gateway is needed)



Product Parameter

Product Name:	RGB+CCT Smart LED Garden Light	IP rate:	IP65
Model No.:	FUTC12ZR	Working Temperature:	-10~40℃
Input voltage:	AC100~240V 50/60Hz	Illumination Distance:	> 20M
Power:	50W	Dimming Level:	4096
Power factor :	> 0.9	Dimming Range:	0.1-100%
CRI :	> 80	Dimming Curve:	logarithm
Color temperature :	2700~6500K	EMC Standard (EMC):	ETSI EN 301 489-1 V2.2.3 ETSI EN 301 489-3 V2.3.2
Luminous Flux :	4600LM	Security Standard (LVD)	EN 62560:2012+A1; 2015+A11:2019
Luminous efficiency:	92LM/W	Radio equipment (RED)	ETSI EN 300 440 V2.2.1
Beam Angle:	15°	Certification:	CE, EMC, LVD, RED
Protocol:	Zigbee 3.0+2.4GHz RF		
Control Distance:	Zigbee: 50M (Open Area) RF: 30M		

Dimension

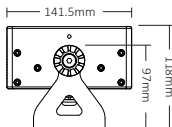
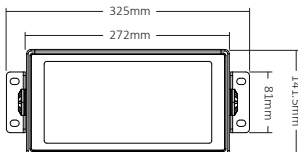

Installation Tips

Please read instruction before installing it, you can contact with our service center if there is any technical issue

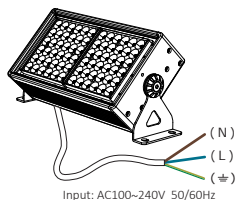

For floodlights, waterproof connector required
(Purchased separately)

Lighting source can not be replaced, please buy new light if the light is over lifetime

Auto-forwarding & Auto-synchronization

Remote control signal auto-forwarding

The remote control signal received by the host will be forwarded to another host within 30m, making the control distance infinite.

Dynamic mode auto-synchronization

In the same dynamic mode, the lamps will be automatically synchronized so that the dynamic effects are always consistent.

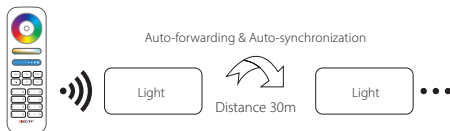

Link/Unlink

Link Light must link with remote before using it

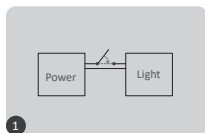

1 turn off light 10 seconds and turn on again



2 short press " | " 3 times within 3 seconds



3 link is done once light flashes 3 times slowly



Link is failed if light doesn't flash, please repeat above steps
(Attention: can not link again if remote already finished linking)

Unlink:

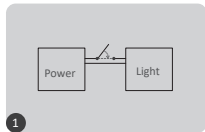

1 turn off light 10 seconds and turn on again



2 short press " | " 5 times within 3 seconds



3 link is done once light flashes 10 times quickly



Unlink is failed if light doesn't flash, please repeat above steps
(Attention: no need to unlink if the light never be linked)

Compatible Remote (purchase separately)



B8



B0



B3 / B3-B / T3



B4 / B4-B / T4



S2-B / S2-W
S2-G



S2W+



S1W+



FUT100



FUT089
FUT089-B



C5



FUT092
FUT092-B



FUT088



FUT096
FUT096-B



WL-Box1



FUTD01

Dynamic mode table selection

Select dynamic mode table 1: While the light is in static mode, short press “**S+**” button 5 times quickly until blue light flashes 3 times slowly.

Select dynamic mode table 2: While the light is in static mode, short press “**S-**” button 5 times quickly until yellow light flashes 3 times slowly.

Dynamic mode table 1 (default)

Number	Dynamic Mode	Brightness / Saturation / Speed
1	Mardi Gras	Adjustable
2	Automatic color change	
3	Sam	
4	Gemstone	
5	Twilight	
6	American	
7	Fat Tuesday	
8	Party	
9	Slow Color Splash	

Dynamic mode table 2 (need to switch manually)

Number	Dynamic Mode	Brightness / Saturation / Speed
1	Colors gradual change	Adjustable
2	White light Gradual change	
3	RGB gradual change	
4	Seven colors jump to change	
5	Jump to change randomly	
6	Red light gradual change +Flash 3 times	
7	Green light gradual change +Flash 3 times	
8	Blue light gradual change +Flash 3 times	
9	White light gradual change +Flash 3 times	

Smartphone APP control instruction

Added Zigbee 3.0 gateway into "Tuya Smart" App (please review instruction of Zigbee 3.0 gateway)

- 1). Connect with power supply.
- 2). Pairing network (**attention: factory default is pairing network**).

Way one: Turn off and turn on light 3 times or over 3 times continuously, the light is in breathing status.

Way two: Long press " SET " key until indicator light flashing.

- 3). Open "Tuya Smart" APP to click Zigbee gateway, then click "Add sub device".
- 4). Click "Indicator is flashing quickly".
- 5). Support APP dimming or group control and etc once added successfully.

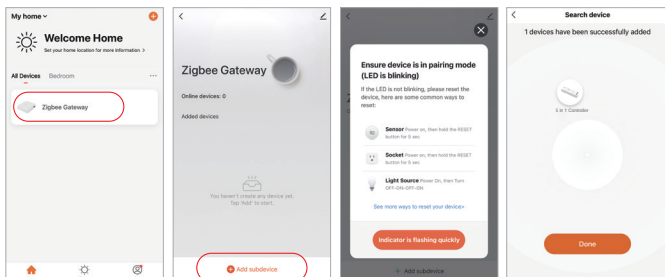

App turn on and off "Do Not Disturb" mode (default activated)

Click the light which need to be set up or group control --- click "More" --- click "Power-on behavior" --- turn on or off

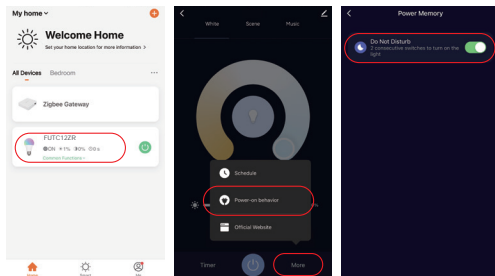

Philips Hue control instruction

Added "Philips Hue" into APP

- 1). Connect with power supply
- 2). Pairing network (**attention: factory default is pairing network**)
Way one: Turn off and turn on light 3 times or over 3 times continuously, the light is in breathing status.
Way two: Long press " SET " key until indicator light flashing.
- 3). Open "Philips Hue" App to click "SETTINGS" and click "Lights"
- 4). Click "+" on the top of right corner
- 5). Click "Search"
- 6). Click "Start configuration", Follow the app instruction to complete configuration

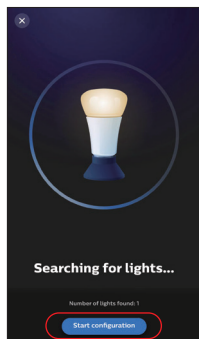
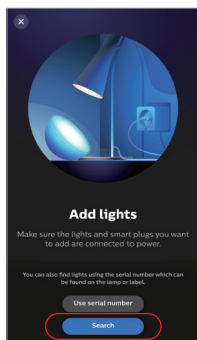
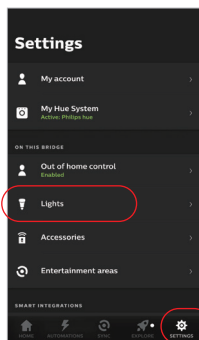

Alexa voice control instruction

1). Alexa control (Audio support Zigbee 3.0 protocol)

Connect Amazon ECHO directly if it's already built-in zigbee 3.0 protocol, following model with zigbee 3.0 protocol:

Amazon ECHO Plus (2nd Gen), ECHO (4th Gen), ECHO Studio, ECHO Show (2. Gen)

- 1). Connect with power supply
- 2). Pairing network (**attention: factory default is pairing network**)

Way one: Turn off and turn on light 3 times or over 3 times continuously, the light is in breathing status.

Way two: Long press " SET " key until indicator light flashing.

- 3). Say to Amazon ECHO "Alexa, Discover devices"

Wait for a while to discover device, Voice control is activated

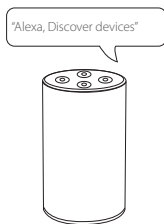

2). Alexa control (Audio don't support Zigbee 3.0 protocol)

Please add device into MiBOXER Zigbee 3.0 gateway if your Alexa don't support zigbee 3.0 protocol, then start following steps

- 1). Open Alexa App
- 2). Click "More" on the bottom of right corner
- 3). Click "Skills & Games"

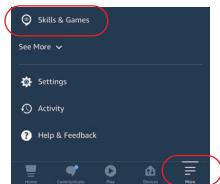

- 4). Click "Q" on the top of right corner
- 5). Type into "Smart life" and search



- 6). Click "Smart Life" skill, follow instruction to finish configuration and start voice control

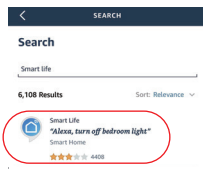

Google Home voice control instruction

Please add device into MiBOXER Zigbee 3.0 gateway and start following steps

- 1). Open Google Home App
- 2). Click "+" on the top of left corner

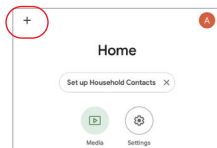

- 3). Click "Set up device"

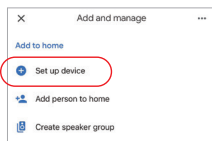

- 4). Click "Works with Google"

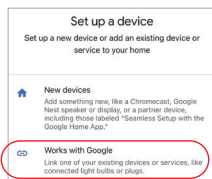

- 5). Click "Q" on the top of right corner
- 6). Type into "Smart life" and search
- 7). Click "Smart Life" skill, follow instruction to finish configuration and start voice control

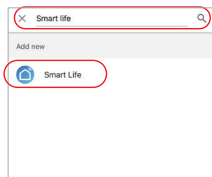

DND mode ON/OFF (factory default is ON)

Turn ON DND:

Short press "OFF" 3 times within 3 seconds and short press "ON" 3 times, DND mode is activated if the light flashes 4 times quickly

Attention: The status of light (ON or OFF) is same as turn on or off mains

Turn off DND

Short press "ON" 3 times within 3 seconds and short press "OFF" 3 times, DND mode is shut down if the light flashes 4 times slowly

Attention: The light is always ON if turn on or off mains

Connection Diagram

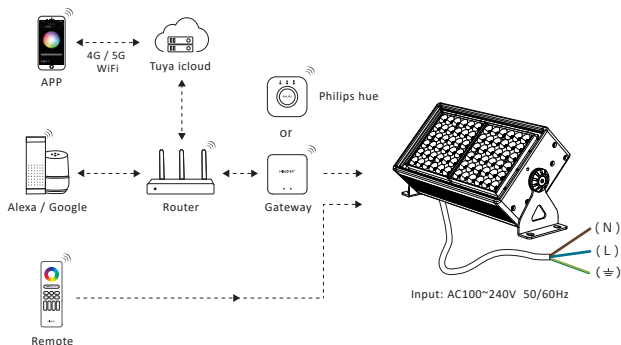

Attention

1. Please turn off power supply before installation.
2. Please ensure input voltage to be same as requirements from device.
3. Don't disassemble device if you are not expert, otherwise it will damage it.
4. Please do not use the light in the place with widely range metal area or strong electromagnetic wave nearby, otherwise, the remote distance will be seriously affected.



Made in China