

## Themis S21-LED-NB-250131

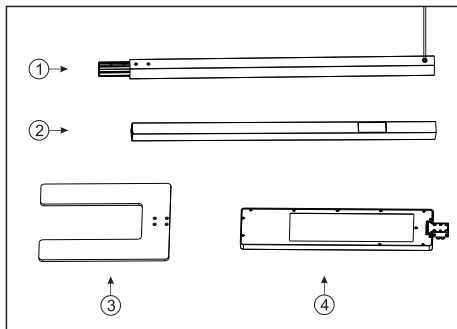

Product list: ① base plate ② lamp body ③ Pole

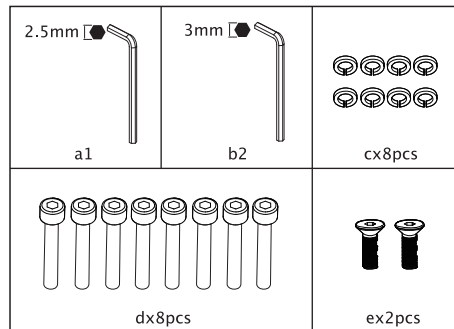

Accessories bag

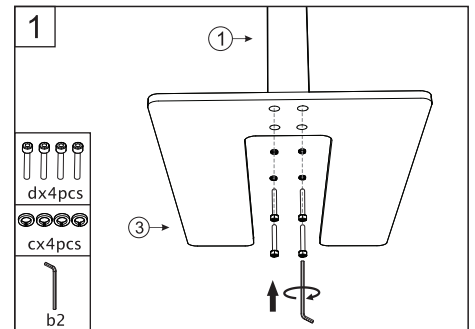

Secure the lamp pole to the base

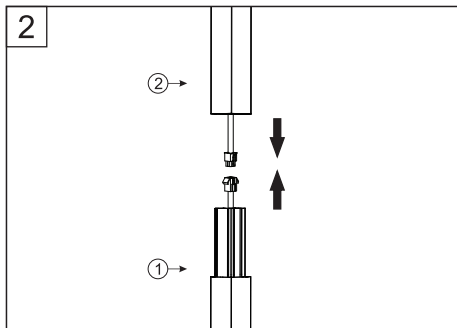

Connect the terminal block

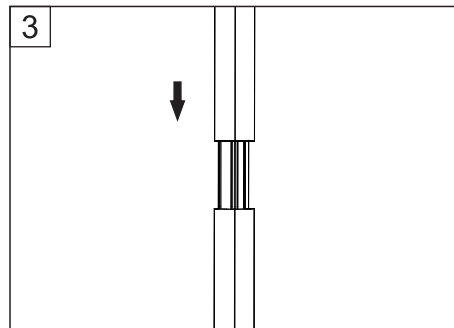

Insert up light pole into one end of down light Fix the light pole pole

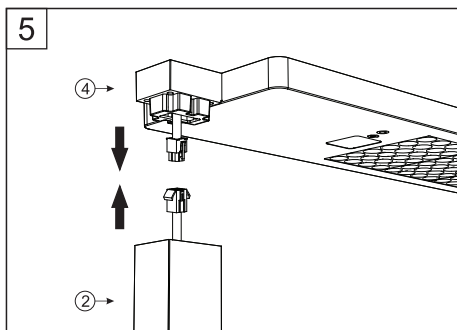
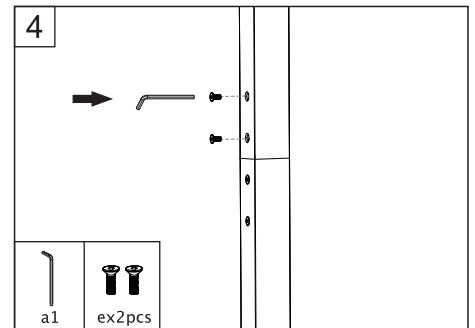

Connect the terminal block

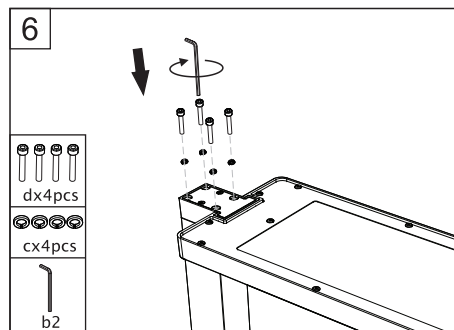

Fix the lamp holder with screws

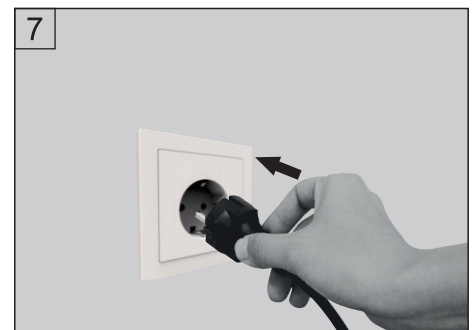

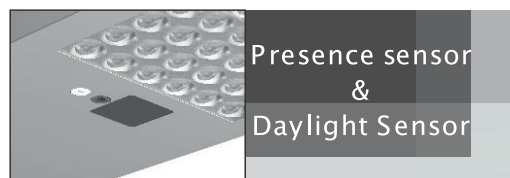
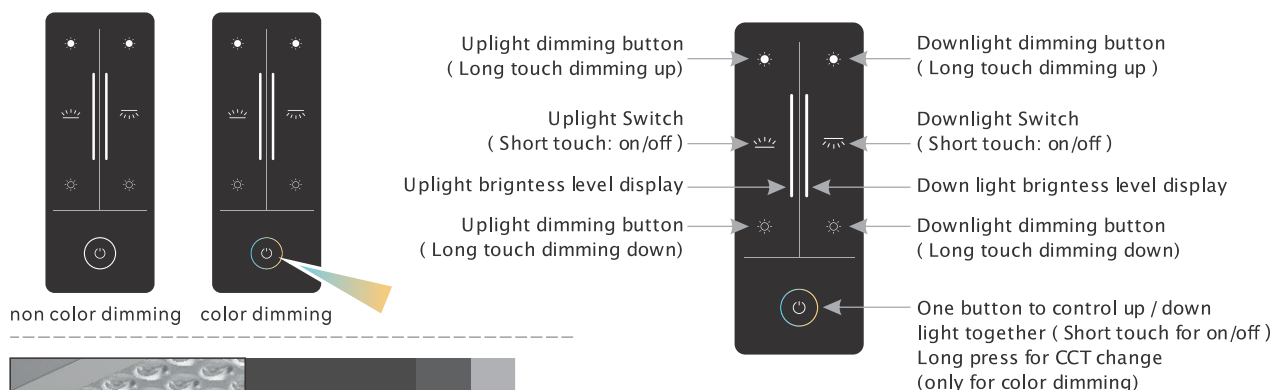

## A. Presence sensor

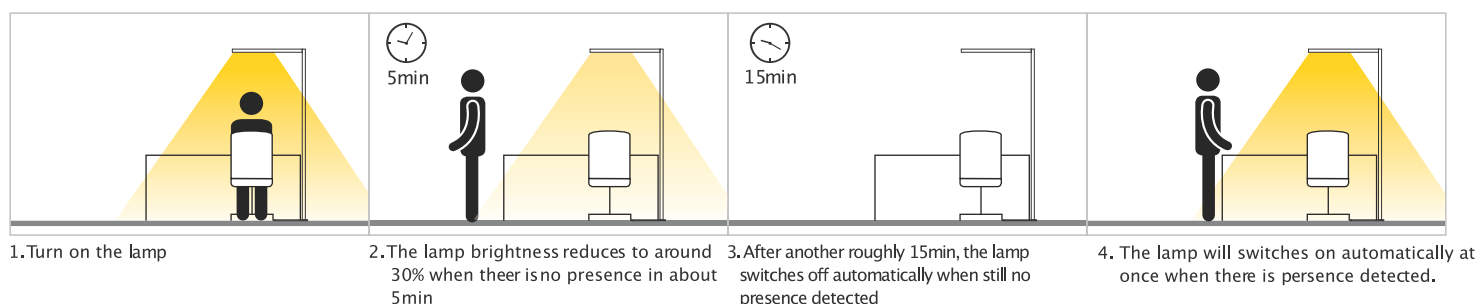

Due to the high sensitivity of the 24G radar sensor module in the light fixture, the following situations may occur where the light is triggered when not manually turned off using the touch panel:

1. Air Conditioning in the Office: If the air conditioning is on, the slight movement of the fan blades and airflow within the sensor's range may trigger the light.
2. Insects, Plants, and Curtains: Slight movements from insects, plants, or curtains within the sensor's range may trigger the light.
3. Metal Enclosed Spaces: In enclosed spaces where the light fixture is surrounded by metal on all sides, interference may cause the light to trigger.
4. Other 2.4G Devices: Other 2.4G devices may potentially interfere with the 24G radar sensor.
5. Same-Type Light Interference: Lights of the same type may trigger each other due to frequency interference.

Recommended Light Placement:

- When placing two lights side by side, the lateral distance between them should be no less than 1.5 meters.
- When placing two lights facing each other, the distance between the sensor modules should be no less than 2.5 meters.

Trigger Distance:

- Presence detection radius: 1 meter (0.4-0.5 meters behind the light pole).
- Movement detection radius: 1.5 meters (0.8-1 meters behind the light pole).

(Note: The distance at which the light is triggered may vary depending on height, body shape, and heart rate.)

Recovery: All light fixtures that are mistakenly triggered can return to normal functionality.

## B. Daylight Sensor

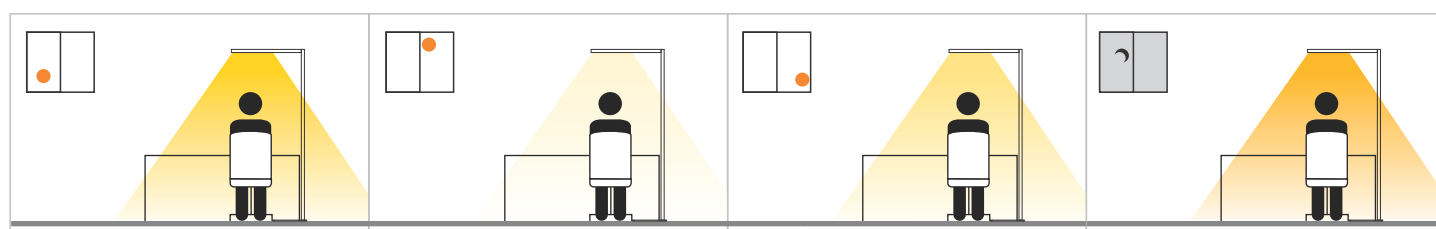

1. Turn on the light and dimming to a comfortable brightness, the daylight sensor will memory this lux value which performance on desk as a standard lux.
  2. When ambient brightness increase (reduce), light will adjust to reduce (increase) its brightness, and guarantee the lux on desk are same to that standard lux, or at least close to that standard lux, it may have around 10% tolerance.
  3. When every time dimming again on light brightness, daylight sensor will memory this new lux value which performance on desk as a new standard lux.
- Attention: The lux value which the light performance on desk will be effected if there is any change on desk within the area of 20° angle under the daylight sensor.

### Detectable area

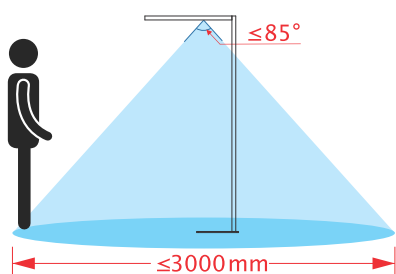

### Here to tell you how to play Presence Sensor & Daylight Sensor

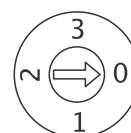
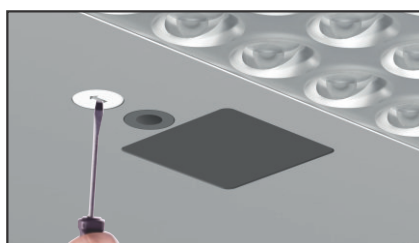

information Dip switches	Presence sensor	Daylight sensor
0	OFF	OFF
1	ON	OFF
2	ON	ON
3	OFF	ON

Adjust the dip switch to the module by screwdriver.

## Installation Steps

- This product complies with the applicable EU directives and safety standards.
- Improper installation or use may lead to fire hazards, electric shocks, or injuries.
- Keep this manual safe and provide it with the product when passed on to others.

## Electrical Safety

- Installation must only be carried out by a qualified electrician according to DIN VDE 0100.
- Before any installation or cleaning, disconnect the circuit completely from the power supply.
- Damaged cables, housings, or connecting wires must not be used – risk of fatal electric shock!

## Cleaning and Maintenance

- Clean only when disconnected from the power supply.
- Use a soft, dry cloth – do not use solvents or alcohol.
- The product is maintenance-free – no user-replaceable parts available.

## Disposal

According to the German Electrical and Electronic Equipment Act (ElektroG):

🔄 Do not dispose of with household waste!

Please return to a certified collection point for electronic waste.

Dispose of packaging materials in an environmentally friendly manner

## This product complies with the requirements of the following directives:

Low Voltage Directive (2014/35/EU)

- EMC Directive (2014/30/EU)
- Ecodesign Directive (2009/125/EC)
- RoHS Directive (2011/65/EU)

The full declaration of conformity can be requested from the manufacturer.

