

**NOTE:**

**ELECTRICAL:**

- 1. VOLTAGE RATING : 125V AC RMS
- 2. CURRENT RATING : 1.5A mp
- 3. CONTACT RESISTANCE : 100 MILLI OHMS MAX
- 4. INSULATION RESISTANCE : 1000M OHMS MIN @ 500V DC
- 5. DIELECTRIC STRENGTH : 750V AC RMS 60Hz, 1MIN
- CAT.6A PERMANENT LINK : CONFORM TO ANSI/TIA-568-C.2 IEC 11801 PL2 CLASS Ea

**Accessory:**

- 1. Instruction Sheet 1pcs

RoHS2.0 AND REACH COMPLIANT

PACKING:1PC/PE BAG+brown box+LABLE 1

Designable

Suitable for central plate of the Germany Company Busch Jaeger and Jung

**ENVIRONMENTAL:**

- 1. STORAGE : -40° TO+85°
- 2. OPERATION : 0° TO+70°
- RJ45 JACK COMPLY TO REQUIREMENTS OF IEC-60603-7-5
- MATES WITH MODULAR PLUG CONFORMING TO FCC PART 68

**MECHANICAL**

- 1. COVER&SHUTTER: FLAME RETARDANT ABS
- 2. JACK HOUSING : PBT+15%GF UL94V0
- 3. PCB : FR-4 THICKNESS:1.6MM
- 4. CONTACT MATERIAL: PHOSPHOR BRONZE T=0.35MM 8P8C 3u"Gold Plated
- 5. IDC CONTACT : PHOSPHOR BRONZE T=0.50MM WITH NICKEL PLATING
- 6. MOUNTING BRACKET: ZINC ALLOY#3
- 7. TOP COVER : ZINC ALLOY#3
- 8. RJ45 JACK LIFE: 750 TIMES MIN
- 9. IDN LIFE : 200 TIMES MIN
- 10. WIRE : AWG 22-24 Cable Conductor OD:0.65MM-0.5MM
- 11. IDC BODY :Krone Type Fireproof PC/ABS UL-94V0/  
With Colour Coded Printing T568A/B
- 12. RETENTIVENESS OF INSERTION STRUCTURE: 50N 60±5s

ITEM NO.	COLOUR
S216358	RAL9010

**SYNERGY 21**

		UPDATE PACKING TYPE	2018-03-20	A2	CUSTOMER	ITEM NO.	S216358			
		UPDATE	2014-06-11	A1	PRODUCT NAME	CAT.6A WALL OUTLET vertical cable entry	MANUFACTURE COUNTRY:	CHINA	UNIT	MM
		NEW	2014-05-12	A	DRAWNBY	CHECKBY	APPOBY	DATE		
BY	CHK	REVISION RECORD MODIFICATIONS	DATE	REV.	SYNERGY 21	SYNERGY 21	SYNERGY 21	2018-03-20		



Face plate+pe bag

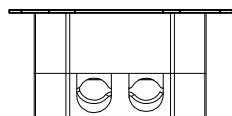

walloutlet+pe bag

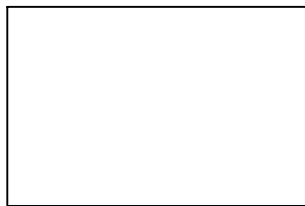

1pcs/small box+user guide+label 1

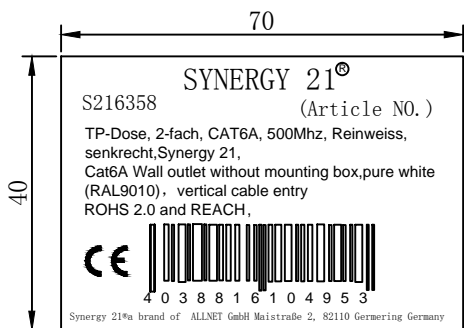

Label 1

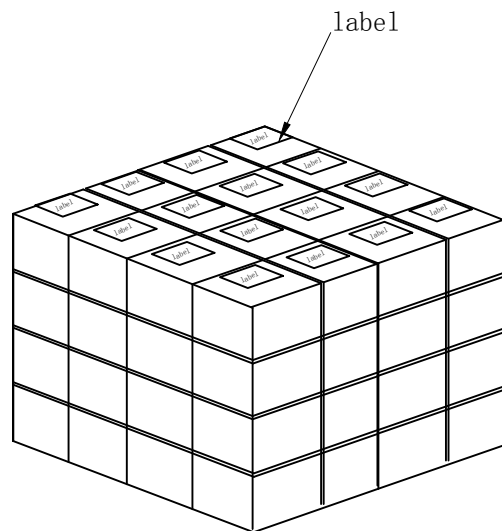

label

SHIPPING MARK

SIDE MARK



PO NO. :  
REACH and ROHS 2.0 Compliant  
MADE IN CHINA

PO NO. :  
Item no:  
Q' TY:  
N. W  
G. W  
Carton no.  
MEAS.

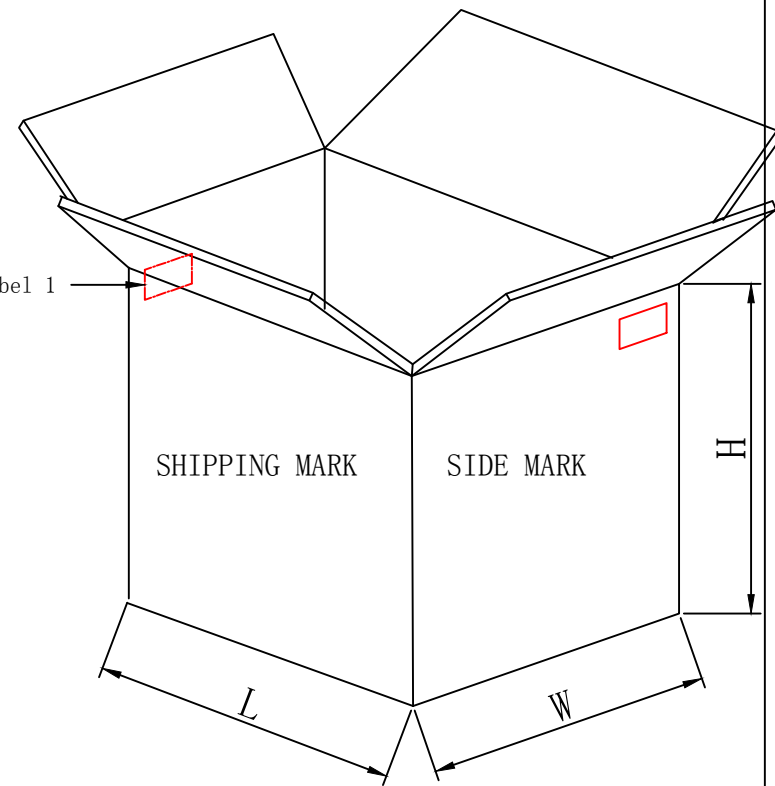

64PCS/ Carton bag+label 1

1. Packing: 1PCS/PE Bag+Inner Carton +instruction+ Label 1, 64PCS/ Carton bag+label 1

2. “工” type sealing

3. “井” type packaging

<b>SYNERGY 21</b>										
CUSTOMER				ITEM NO.		S216358				
PRODUCT NAME		PACKING		MANUFACTURE COUNTRY:		CHINA		UNIT MM		
DRAWNBY		CHECKBY		APPOBY		DATE				
BY	CHK	REVISION RECORD MODIFICATIONS			DATE	REV.	SYNERGY 21	SYNERGY 21	SYNERGY 21	2018-03-20

UPDATE PACKING TYPE

2018-03-20 A2

NEW

2014-06-11 A

REVISION RECORD MODIFICATIONS

DATE REV.

SYNERGY 21 SYNERGY 21 SYNERGY 21 2018-03-20

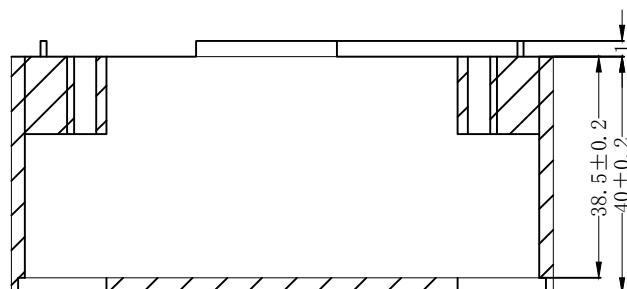
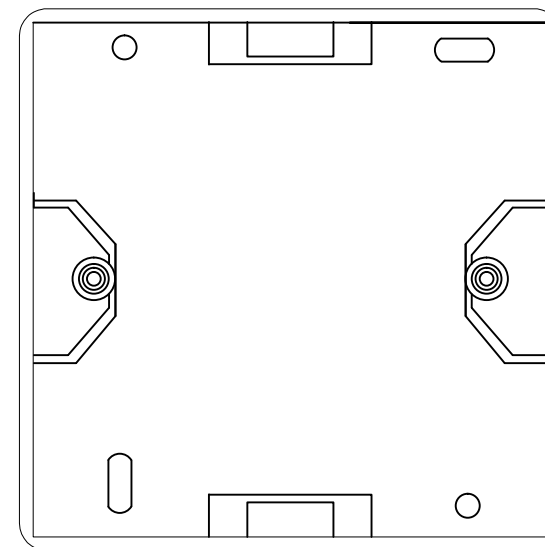
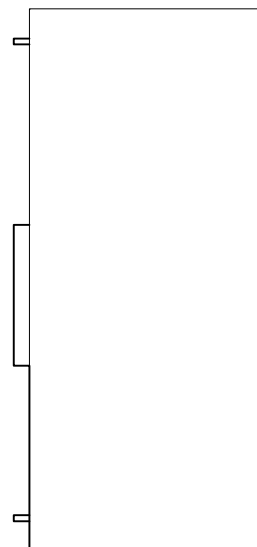
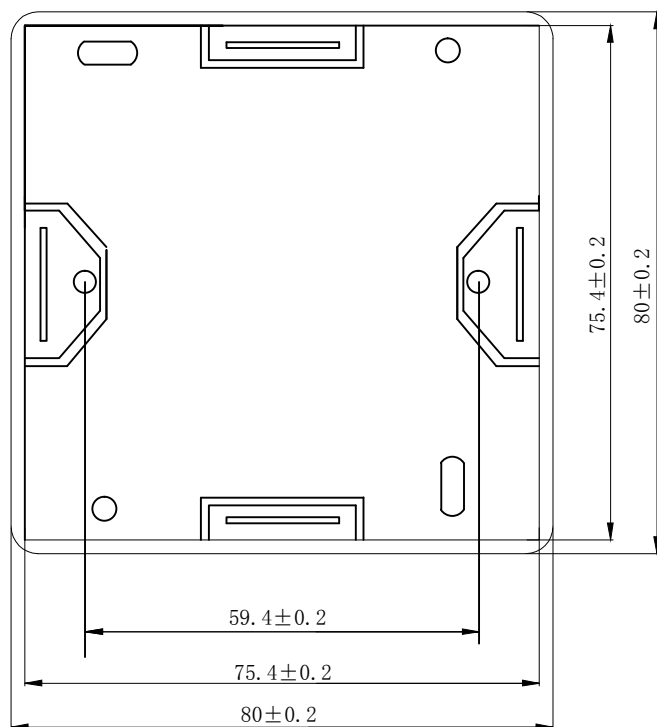

ITEM NO.	COLOUR
S216328	Pure White RAL9010
S216329	Pearl White RAL1013

**NOTE:**  
 MATERIAL: ABS  
 SIZE: 80MM\*80MM\*40MM  
 RoHS2.0 AND REACH COMPLIANT  
 ACCESSORY: SCREW M3\*14 2PCS

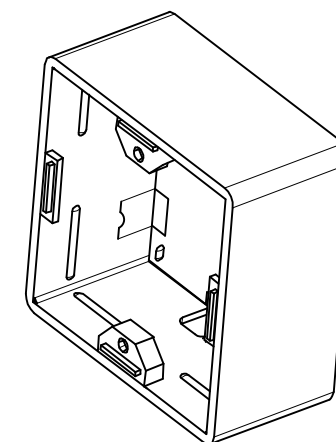

		UPDATE PACKING TYPE			2018-03-20	A3	SYNERGY 21					
		UPDATE PRODUCT			2014-09-24	A2	CUSTOMER		ITEM NO.	see the chart		
		UPDATE ROHS COMPLIANT			2013-07-10	A1	PRODUCT NAME	mounting box	manufacture country:	CHINA	UNIT	MM
		NEW			2011-07-11	A	DRAWNBY	CHECKBY	APPOBY	DATE		
BY	CHK	REVISION RECORD MODIFICATIONS			DATE	REV.	SYNERGY 21	SYNERGY 21	SYNERGY 21	2018-03-20		

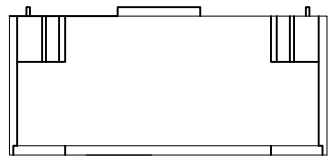

mounting box+pe bag

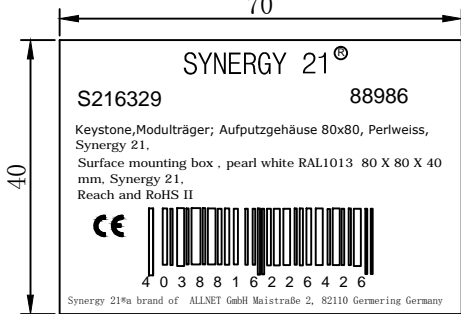
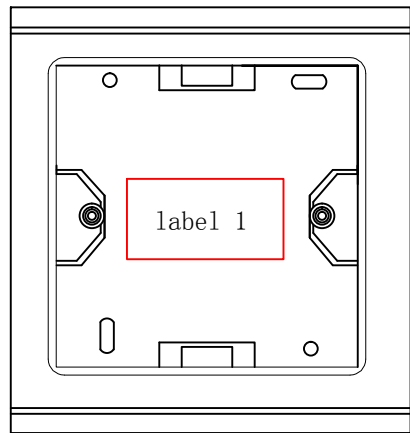

pe bag label

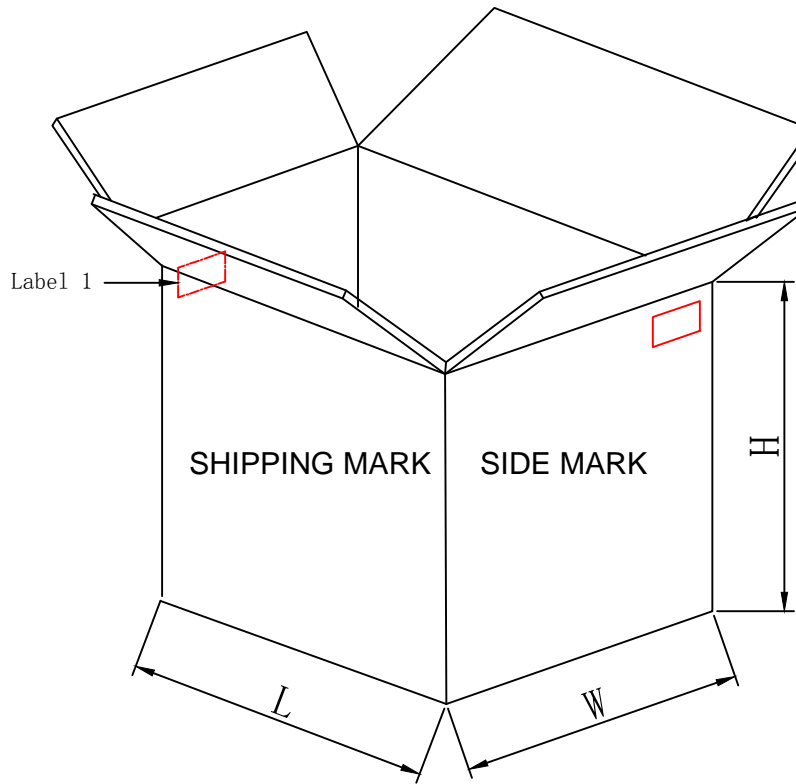
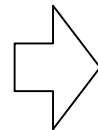

96PCS/CTN+LABEL 1

SHIPPING MARK



PO NO. :  
REACH and ROHS 2.0 Compliant  
MADE IN CHINA

SIDE MARK

PO NO. :  
Item no:  
Q' TY:  
N. W  
G. W  
Carton no.  
MEAS.

1. Packing: 1PCS/PE Bag A+Label 1, 96PCS/CTN+LABEL 1
2. “工” type sealing
3. “井” type packaging

SYNERGY 21												
					CUSTOMER				ITEM NO.	see the chart		
UPDATE PACKING TYPE					2018-03-20	A3	PRODUCT NAME	PACKING	manufacture country:	CHINA	UNIT	MM
NEW							DRAWNBY	CHECKBY	APPOBY	DATE		
BY	CHK	REVISION RECORD MODIFICATIONS			DATE	REV.	SYNERGY 21	SYNERGY 21	SYNERGY 21	2018-03-20		