

Installation instruction

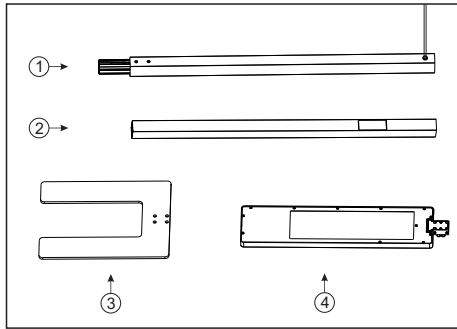

Product list: ① base plate ② lamp body ③ Pole

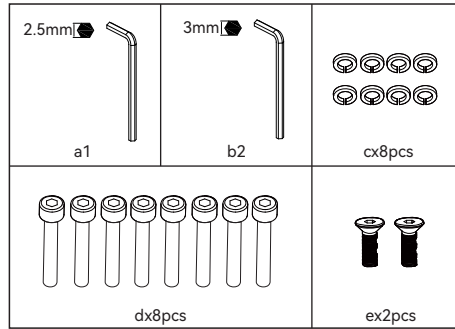

Accessories bag

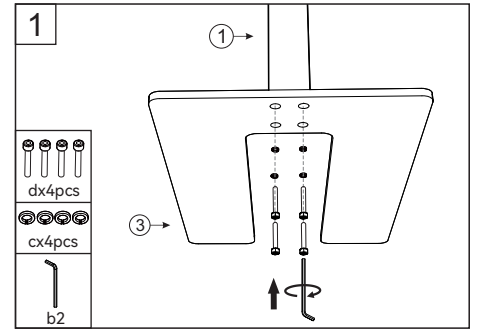

Secure the lamp pole to the base

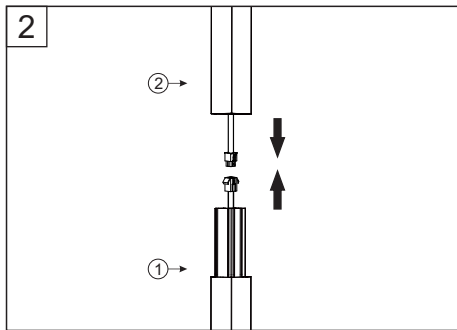

Connect the terminal block

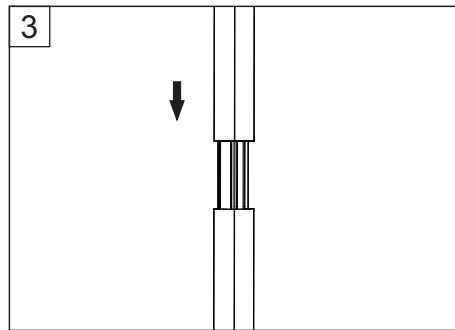

Insert up light pole into one end of down light pole

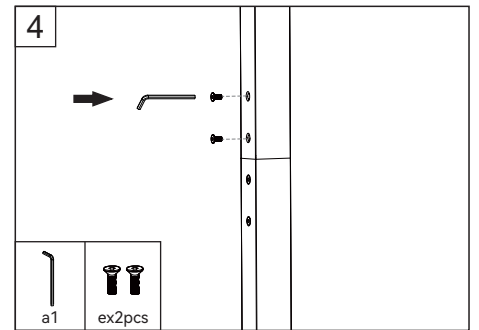

Fix the light pole

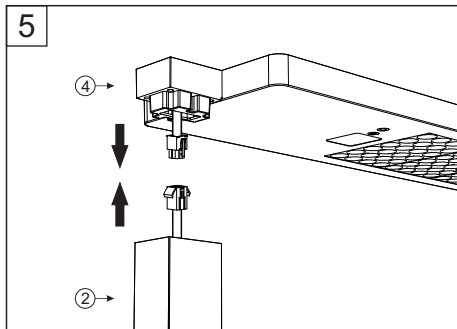

Connect the terminal block

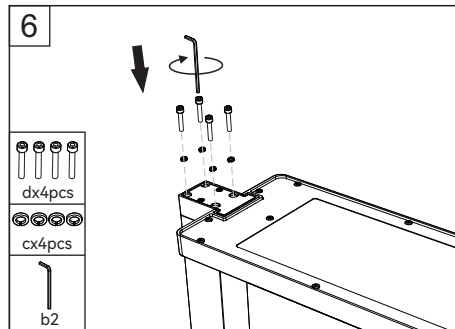

Fix the lamp holder with screws

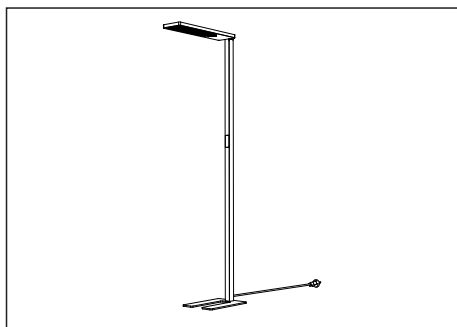
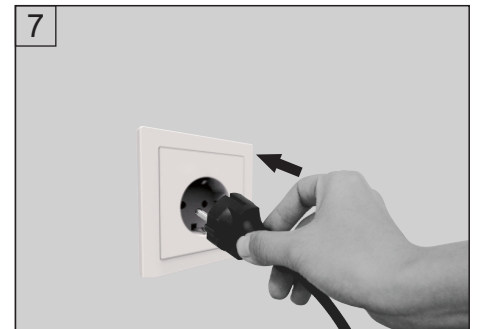

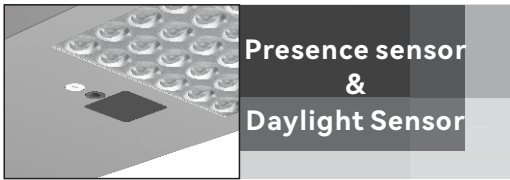
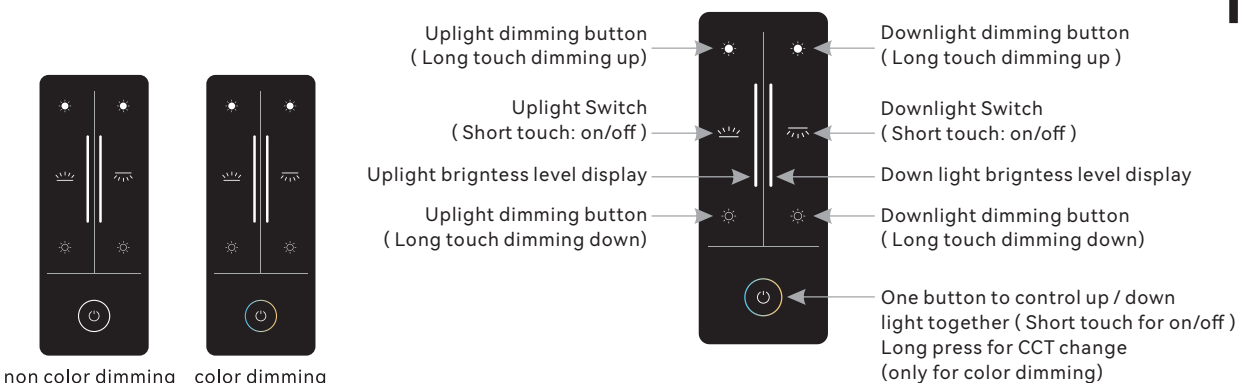

A.Presence sensor

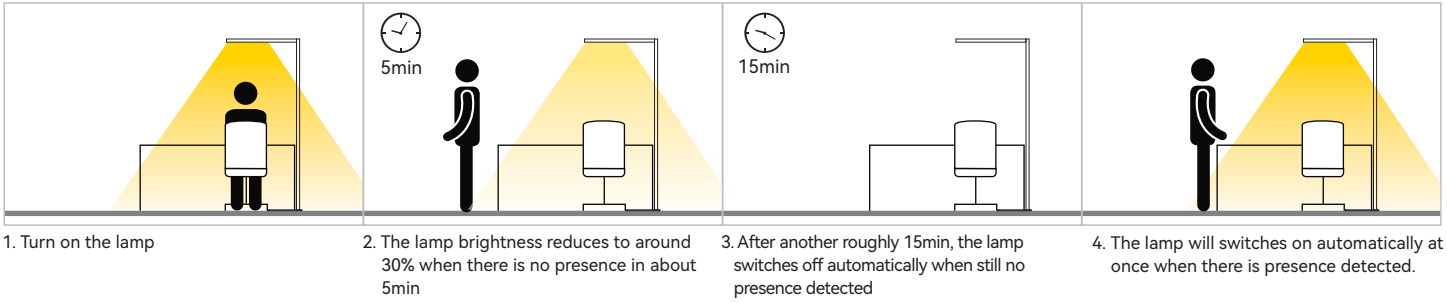

Due to the high sensitivity of the 24G radar sensor module in the light fixture, the following situations may occur where the light is triggered when not manually turned off using the touch panel:

- 1.Air Conditioning in the Office: If the air conditioning is on, the slight movement of the fan blades and airflow within the sensor's range may trigger the light.
- 2.Insects, Plants, and Curtains: Slight movements from insects, plants, or curtains within the sensor's range may trigger the light.
- 3.Metal Enclosed Spaces: In enclosed spaces where the light fixture is surrounded by metal on all sides, interference may cause the light to trigger.
- 4.Other 2.4G Devices: Other 2.4G devices may potentially interfere with the 24G radar sensor.
- 5.Same-Type Light Interference: Lights of the same type may trigger each other due to frequency interference.

Recommended Light Placement:

- When placing two lights side by side, the lateral distance between them should be no less than 1.5 meters.
- When placing two lights facing each other, the distance between the sensor modules should be no less than 2.5 meters.

Trigger Distance:

- Presence detection radius: 1 meter (0.4-0.5 meters behind the light pole).
- Movement detection radius: 1.5 meters (0.8-1 meters behind the light pole).

(Note: The distance at which the light is triggered may vary depending on height, body shape, and heart rate.)

Recovery: All light fixtures that are mistakenly triggered can return to normal functionality.

B.Daylight Sensor

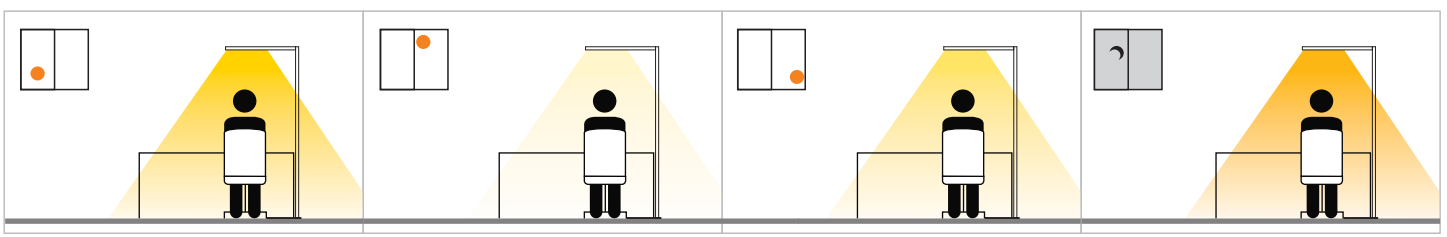

Detectable area

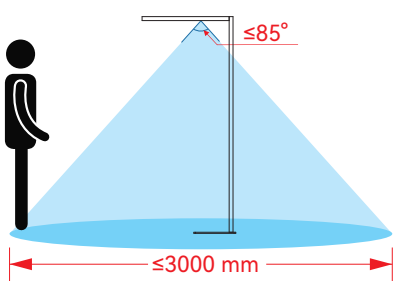

Here to tell you how to play Presence Sensor & Daylight Sensor

information Dip switches	Presence sensor	Daylight sensor
0	OFF	OFF
1	ON	OFF
2	ON	ON
3	OFF	ON

Adjust the dip switch to the module by screwdriver.

1. Product Description

The Synergy 21 LED Office Line floor lamp Themis is an energy-efficient LED standing lamp designed for workplace lighting. It combines direct and indirect lighting with dimmable control, motion detection, and daylight sensors.

2. Intended Use

This lamp is intended solely for indoor lighting (offices, workplaces, conference rooms).

Any other use is considered improper and may result in damage or hazards.

3. Safety Instructions

- Installation and maintenance must be carried out by qualified personnel only.
- Connect only to a proper power supply (100–240 V, 50–60 Hz).
- Do not use the lamp in damp or explosive environments.
- Do not open the lamp – no user-serviceable parts inside.
- Disconnect and stop using the lamp immediately if cables or housing are damaged.
- Keep children away from installation and operation.

4. Technical Data

- Power consumption: 100 W (88 W Up / 12 W Down)
- Luminous flux: 13,000 lm (11,500 lm Up / 1,500 lm Down)
- Color temperature (CCT): 3000K – 5700K (adjustable)
- Color rendering index (CRI): >80
- UGR: <14 with downward light
- Beam angle: 40° (down) / 100° (up)
- Power supply: 100–240 V
- Operating temperature: -20 °C to +40 °C
- Dimensions: Height 2000 mm / Base 320 x 420 mm / Lamp head 160 x 670 x 23 mm
- Weight: 11.4 kg
- Material: Aluminum
- Color: White (RAL9003), also available in Black or Silver on request

5. Assembly & Installation

1. Unpack the lamp and check all components for completeness.
2. Place the base on a stable, level surface.
3. Align the lamp vertically.
4. Connect the power plug to a suitable socket (100–240 V).
5. Ensure that sensors are not obstructed.

6. Operation

- Switch on/off & dimming: Via integrated touch dimmer.
- Automatic mode: Motion and daylight sensor automatically activate the lamp.
- Color temperature adjustment: Stepless adjustment between 3000K and 5700K.

7. Maintenance & Care

- Clean the lamp regularly with a soft, dry cloth.
- Do not use aggressive cleaning agents or solvents.
- Always disconnect the lamp from the power supply before cleaning.

8. Troubleshooting

- Lamp does not switch on: Check power supply and verify proper plug connection.
- Flickering light: Verify power stability, contact qualified personnel if issue persists.
- Sensor not responding: Ensure the detection area is unobstructed.

9. Disposal

Do not dispose of the lamp with household waste.

Please return it to an appropriate collection point for electrical and electronic equipment (Directive 2012/19/EU – WEEE).

10. Manufacturer Information

Manufacturer:

ALLNET GmbH

Maistr. 2

82110 Germering

Germany

This product complies with the applicable EU directives (CE marked).